

# Shadow Lite Inc

68939 M-103  
White Pigeon, Mi 49099

Ph: 269.483.2304  
Fax: 269.483.2369

[www.shadow-lite.com](http://www.shadow-lite.com)



## Shadow Lite Truck Camper Specifications

	8.5 SSB	8.5 DSB	8.5 SLB	8.5 DLB	9.5 SSB	9.5 DSB	9.5 SLB	9.5 DLB
Total Width	7' /6"	7' /6"	7' /6"	7' /6"	7' /6"	7' /6"	7' /6"	7' /6"
Total Length	16' 8"	16' 8"	16' 8"	16' 8"	17' /8"	17' /8"	17' /8"	17' /8"
Floor Length	8' /8"	8' /8"	8' /8"	8' /8"	9' /8"	9' /8"	9' /8"	9' /8"
Wheel Well Floor Width	47"	47"	47"	47"	47"	47"	47"	47"
Int. Ceiling Height	77 1/2"	77 1/2"	77 1/2"	77 1/2"	77 1/2"	77 1/2"	77 1/2"	77 1/2"
LP Bottles	(1)20 lb.	(1)20 lb.	(1)20 lb.	(1)20 lb.	(2)20 lb.	(2)20 lb.	(2)20 lb.	(2)20 lb.
Fresh Water Tank	30 gal.	30 gal.	30 gal.	30 gal.	30 gal.	30 gal.	30 gal.	30 gal.
Gray Water Tank	10 gal.	10 gal.	10 gal.	10 gal.	23 gal.	23 gal.	23 gal.	23 gal.
Black Water Tank	6 gal.	6 gal.	6 gal.	6 gal.	6 gal.	8 gal.	8 gal.	8 gal.
Stainless Sink w/Cover	Single	Single	Single	Single	Double	Double	Double	Double
Bed Size	Queen	Queen	Queen	Queen	Queen	Queen	Queen	Queen
Dry Weight	2231 lbs.	2186 lbs.	2163 lbs.	2226 lbs.	n/a	2465 lbs.	2401 lbs.	2463 lbs.

### Standard Exterior Features

Aerodynamic Fiberglass Front Cap (Increase Mileage)  
 Extended Cab Over  
 Fiberglass Rear Columns (Cuts Down on Drag and Rear Vacuum)  
 Awning Rail  
 Electric Jacks w/Remote Control  
 Roof-Rack and Ladder  
 Powder Coated Steel Bumper with Storage for Sewage Hose, etc.  
 L.E.D. Running Lights  
 Rear Brake Light Above Entry Door  
 Side and Rear 110-volt GFI Outlets  
 7-way Rear Plug  
 Two (2) Patio Lights (Curb Side and Rear)  
 Exterior Cable Hook-up  
 30-amp Removable Power Cord  
 Radius Tinted Safety Glass Windows  
 Slider Cab Window  
 Egress Bunk Window  
 Screened Entrance Door with Deadbolt Lock  
 Graphics Package  
 City Water Connection  
 Outside Shower  
 Portable Water Fill  
 Rubber Truck Bed Bumpers  
 Lighted License Plate Holder  
 Swing Out Grab Handle (8 1/2 at entry)  
 9.5 Models have Ladder  
 3-Step Scissor Steps

### Standard Interior Features

Folding Pedestal Table (Allows More Floor Space)  
 Laminated Wood Grain Floor  
 Storage for Table Top and Pedestal Legs  
 Queen Bed Mattress (foam) with Bedspread  
 Storage (Overhead Cab Area and Dinette Base)  
 Privacy Drape (Overhead Cab Area)  
 Soft Touch Vinyl Ceiling (Washable)  
 Hard Maple Cabinetry-Natural or Cherry Stained  
 Solid Wood Drawers  
 No Trim or Gimp necessary to Hide Imperfections  
 Adjustable Power Vents (in and out) Speed Control  
 Skylight in Ceiling Over Bath  
 Light Switch at Entry Door (Patio Light)  
 GFI-110 Outlets  
 Cable Ready  
 16,000 BTU-Electric Ignition Furnace  
 55- amp Converter with Charger  
 Gas/Electric 6-gal.-DSI Water Heater  
 Water Heater by-pass (For Winterization)  
 5 CF 3-way Refrigerator  
 3-Burner Range with Oven and Stove Cover  
 Slide-out Pantry with Can Good Fixture  
 Light Range Hood  
 Monitor Panel  
 Bath with Shower and Lavatory  
 Thetford Toilet  
 Demand Water Pump  
 Laminated Countertop and Sliding Table Top  
 Pleated Shades and Valances

### Available Options

For Short Bed or Long Bed Trucks  
 Sofa or Dinette in Dining Area  
 Fabric Choices: Woodlands (Earth tones) Wetlands (Blue)  
 Microwave Oven  
 Awnings  
 13,500 BTU Air Conditioner  
 Heat Strip (For A/C)  
 Generator Ready (Portable)  
 \*AM/FM/CD/IP Entertainment Center with (4)Speakers  
 \*T.V. Antenna and Booster  
 \*19" Flat Screen T.V.  
 Electronic Pkg. ( \*includes these items)

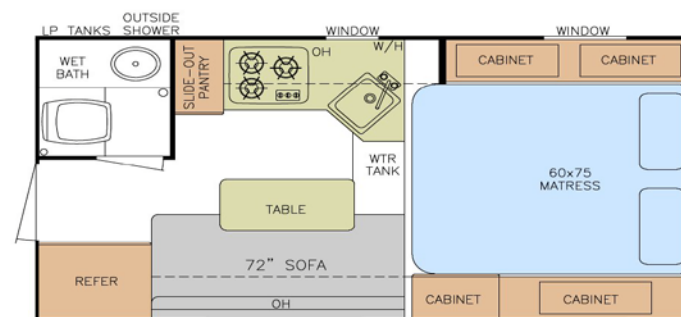

8.5 SLB  
8.5 SSB

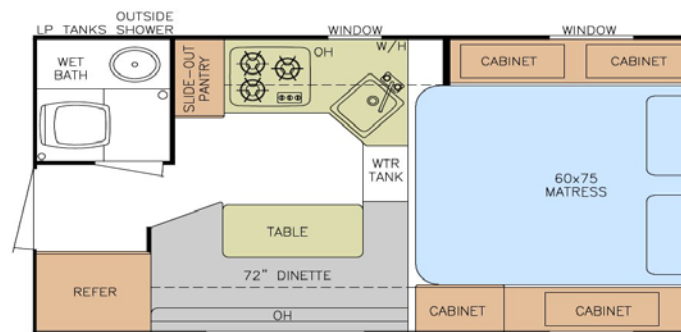

8.5 DLB  
8.5 DSB

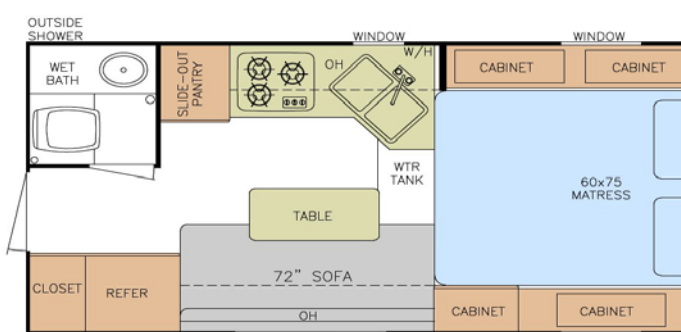

9.5 SLB  
9.5 SSB

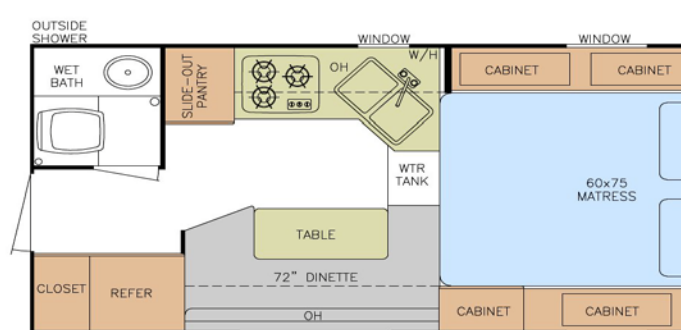

9.5 DLB  
9.5 DSB

### Your Nearest Dealer

